

Modular Removable Core Locking Systems

The Concept

- > Lock bodies are selected to meet the requirements of the cabinet, door, drawer or drawers
- > The cores and keys are selected to meet the requirements for security, key control, locking plan and costs

Benefits

- > If keys are lost, an owner may elect to replace the lock cores without removing the lock bodies
- > Manufacturing processes and planning can progress without selection of keying requirements
- > Manufacturers can create locking standards and offer varied levels of security based on keyway, key and core selection
- > Manufacturers can fully produce like cabinets to inventory
- > Keying requirements can be achieved with only the addition of cores and keys, installable at the project site

Components

- > Keys: User Keys, Master Keys, Removal Keys
- > Cores
- > Lock Bodies
- > Accessories

Häfele offers two modular systems:

(Components are not interchangeable)

→ Timberline

- > Timberline provides an anti-tip system included in this section

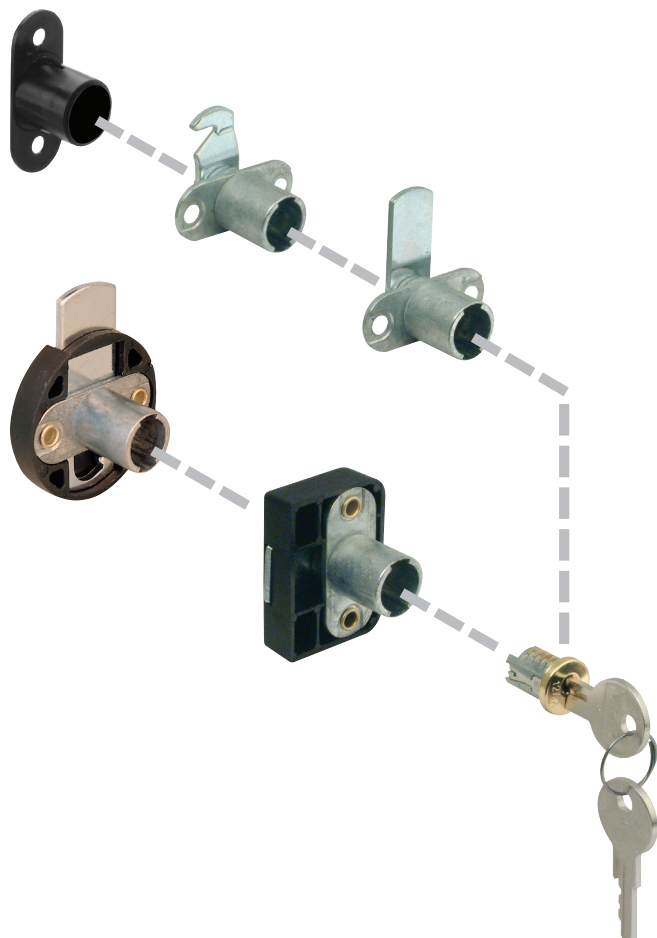

→ SYMO 3000

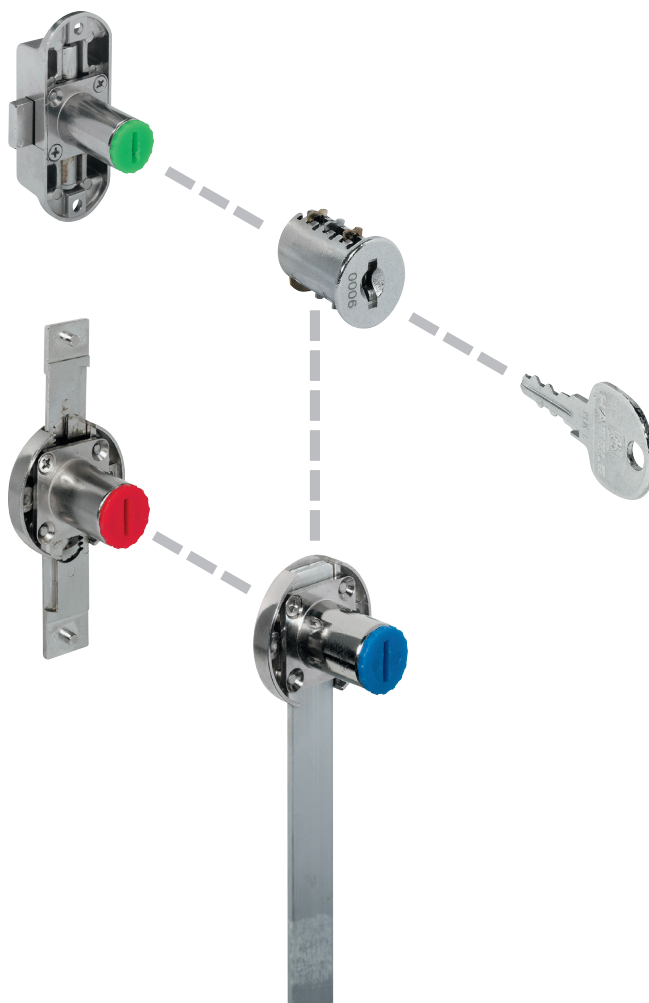

Timberline Modular Removable Core Locking System

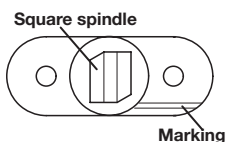
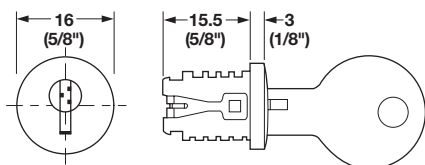

Note

The cylinder housings and lock cores are marked (see diagram above). A series of furniture doors can all be locked with the same direction of turn if the markings are positioned identically.

- > Separates the lock core from cylinder housing
- > Any combination of locking systems can be obtained
- > Manufacturer can install fully functional locking systems
- > Simplifies the planning and changing of locking systems
- > Lock cores can be replaced with the aid of the removal key

→ Snap-In Lock Core

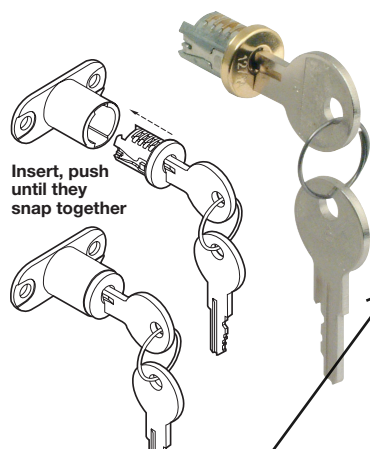

1. Pick a finish

- > For any cylinder body
- > 5 plate levers = 900 possible key changes
- > Material: Zinc die-cast, unfinished; Plate levers: Brass; Keys: Brass; Finish: nickel-plated

Keyed Different

Lock face	nickel polished	nickel matt	brass polished	bronzed epoxy	black epoxy	white epoxy
Item No.	210.04.606	210.04.710	210.04.803	210.04.106	210.04.302	210.04.500
Timberline No.	LP-100	LP-700	LP-500	LP-400	LP-300	LP-820

Keyed Alike

Lock face	nickel polished	nickel matt	brass polished	bronzed epoxy	black epoxy	white epoxy
Keying #'s	Item No.					
100 TA	210.04.615	210.04.720	210.04.812	210.04.115	210.04.311	210.04.510
101 TA	210.04.624	210.04.721	210.04.821	210.04.124	210.04.320	210.04.511
102 TA	210.04.633	210.04.722	210.04.830	210.04.133	210.04.339	210.04.512
103 TA	210.04.642	210.04.723	210.04.849	210.04.142	210.04.348	210.04.513
104 TA	210.04.651	210.04.724	210.04.858	210.04.151	210.04.357	210.04.514
105 TA	210.04.660	210.04.725	210.04.867	210.04.160	210.04.366	210.04.515
106 TA	210.04.679	210.04.726	210.04.876	210.04.179	210.04.375	210.04.516
107 TA	210.04.688	210.04.727	210.04.885	210.04.188	210.04.384	210.04.517
108 TA	210.04.697	210.04.728	210.04.894	210.04.197	210.04.393	210.04.518
109 TA	210.04.704	210.04.729	210.04.901	210.04.204	210.04.400	210.04.519

Supplied With
2 Keys

2. Key different or alike?

Dimensional data not binding. Dimensions in mm, inches are approximate. We reserve the right to alter specifications without notice.

Timberline Modular Removable Core Locking System

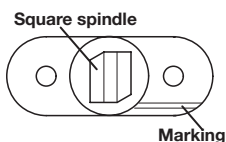
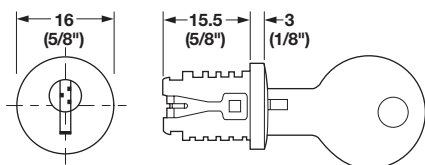

Note

The cylinder housings and lock cores are marked (see diagram above). A series of furniture doors can all be locked with the same direction of turn if the markings are positioned identically.

- > Separates the lock core from cylinder housing
- > Any combination of locking systems can be obtained
- > Manufacturer can install fully functional locking systems
- > Simplifies the planning and changing of locking systems
- > Lock cores can be replaced with the aid of the removal key

→ Cylinder Rosette

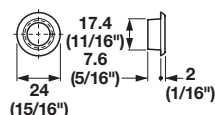

3. Need a Rosette the same color as the lock

- > For any cylinder body
- > Material: Steel

Finish	Timberline No.	Item No.
nickel polished	BZ-100	210.04.062
nickel matt	BZ-700	210.04.070
brass polished	BZ-500	210.04.054
bronzed	BZ-400	210.04.017
black	BZ-300	210.04.035
white	BZ-800	210.04.071

Note

Requires Ø19 mm (3/4 inch) hole for installation with lock cylinder.

→ Protective Cap



- > Keeps interior of cylinder housing free of paint and dirt after lock is installed
- > Material: PVC

Color	Timberline No.	Item No.
orange	CC-100	210.02.095

→ Removal Key



- > To remove lock cores
- > Material: Brass

Timberline No.	Item No.
KY-500-TA	210.02.004

→ Master Key



- > Fits all TA lock cores, see page 10.5
- > Material: Brass

Timberline No.	Item No.
KY-101-TA	210.02.059

→ Replacement Key



- > Special order only
- > Specify key number at time of order
- > Material: Brass

Item No.
210.02.009

typical for drawers or
single doors

Timberline Modular Removable Core Locking System

→ **Deadbolt Lock**

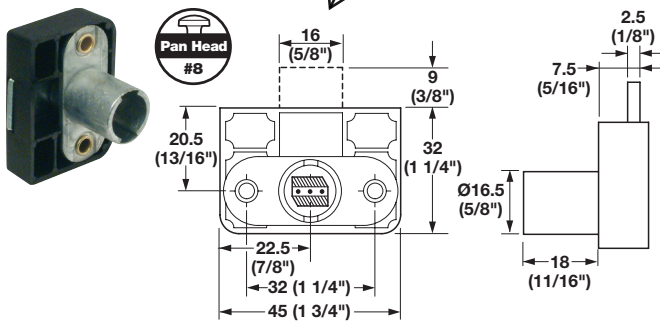

- > Throw: 9 mm (3/8")
- > Material: Lock case: Nylon; Color: black
Cylinder housing: Zinc die-cast, unfinished
Bolt: Steel; Finish: nickel-plated

Mounting	Timberline No.	Item No.
Left hand/right hand	CB-290	232.12.302
Drawer	CB-280	232.12.311

→ **Deadbolt Lock with extended bolt**

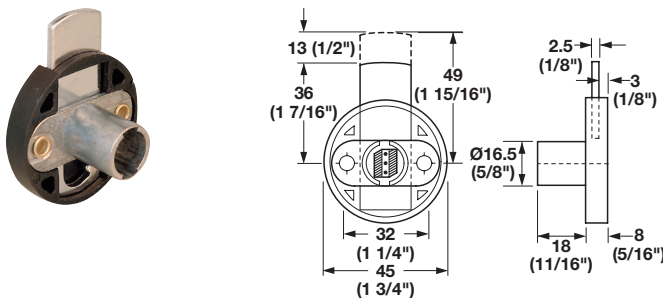

- > Bolt starts at 36 mm (1 7/16") and extends to 49 mm (1 15/16")
- > Rotate cylinder core 180° to install
- > Material: Lock case: Nylon; Color: black
Cylinder housing: Zinc die-cast, unfinished
Bolt: Steel; Finish: nickel-plated

Mounting	Timberline No.	Item No.
Left hand/right hand	CB-241	232.18.306
Drawer	CB-231	232.18.316

→ **Deadbolt Lock**

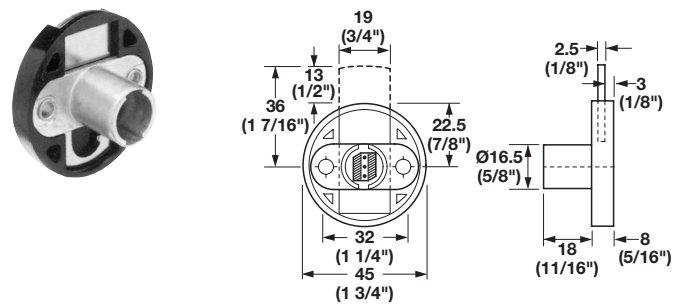

- > Throw: 9 mm (3/8")
- > Rotate cylinder core 180° to install
- > Material: Lock case: Nylon; Color: black
Cylinder housing: Zinc die-cast, unfinished
Bolt: Steel; Finish: nickel-plated

Mounting	Timberline No.	Item No.
Left hand/right hand	CB-240	232.18.304
Drawer	CB-230	232.18.313

→ **Deadbolt Lock with extended bolt**

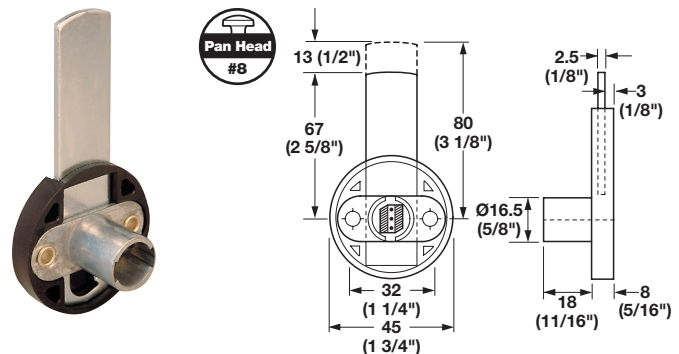

- > Bolt starts at 67 mm (2 5/8") and extends to 80 mm (3 1/8")
- > Rotate cylinder core 180° to install
- > Material: Lock case: Nylon; Color: black
Cylinder housing: Zinc die-cast, unfinished
Bolt: Steel; Finish: nickel-plated

Mounting	Timberline No.	Item No.
Left hand/right hand	CB-242	232.18.322
Drawer	CB-232	232.18.332

Timberline Modular Removable Core Locking System

→ Deadbolt Lock for double doors

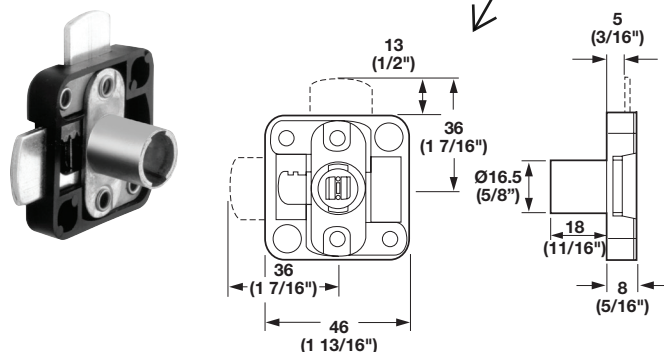

Check for strike
plates

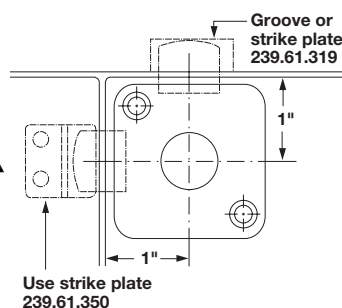

- > With straight bolts
- > Throw: 13 mm (1/2")
- > Locks both doors without the need for lock strips or a spring catch
- > Material: Lock case: Nylon; Color: black
Cylinder housing: Zinc die-cast

Mounting	Timberline No.	Item No.
Lower left hand or upper right hand	CB-250	232.35.300
Lower right hand or upper left hand	CB-255	232.35.301

→ Deadbolt Lock for double doors

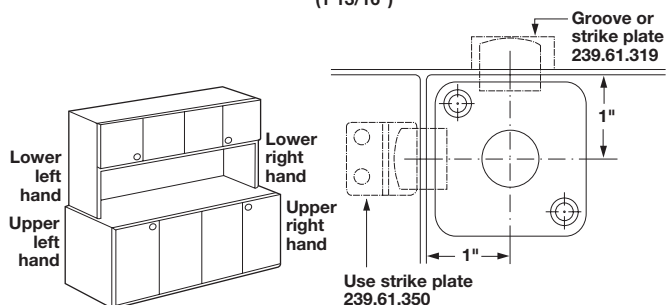
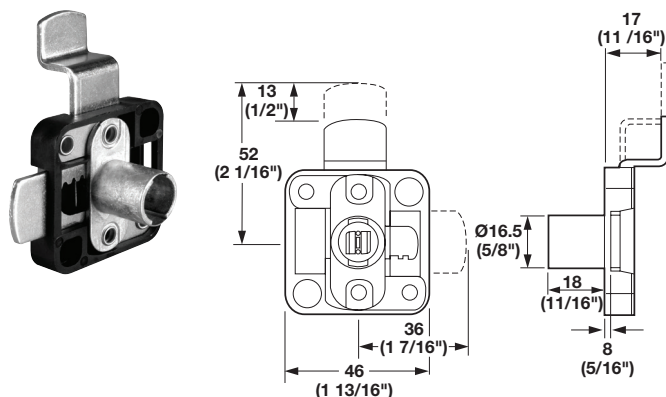

- > With offset bolt for overlay doors
- > Throw: 13 mm (1/2")
- > Material: Lock case: Nylon; Color: black
Cylinder housing: Zinc die-cast

Mounting	Timberline No.	Item No.
Lower left hand or upper right hand	CB-251	232.35.302
Lower right hand or upper left hand	CB-256	232.35.303

→ Deadbolt Lock with offset bolt

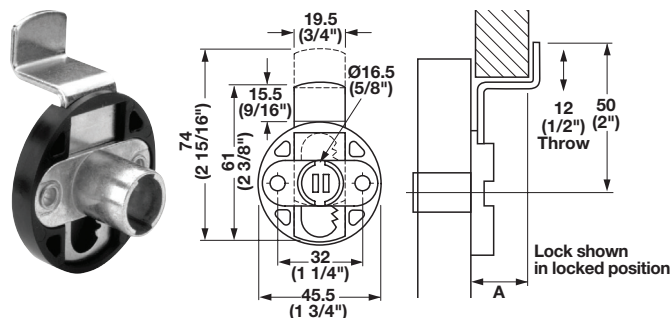

- > For face-frame cabinets
- > Throw: 13 mm (1/2")
- > Rotate cylinder core 180° to install
- > Material: Lock case: Nylon; Color: black
Cylinder housing: Zinc die-cast, unfinished
Bolt: Steel; Finish: nickel-plated

Mounting	A	Timberline No.	Item No.
Left hand/right hand	15 (9/16")	CB-244	232.18.348
Drawer	15 (9/16")	CB-234	232.18.358
Left hand/right hand	22 (7/8")	CB-245	232.18.350
Drawer	22 (7/8")	CB-235	232.18.360